

Important Information

This instruction leaflet can be used for the AURA BENCH rectangular or wave set of 2 desk configuration.

Safety Guide

- Apply manual handling guidelines when building this item.
- Only use component fixings supplied with this item.

Recommendations

Levelling the Bench desk

It is important to adjust the feet at the start and finalise at the end to ensure the product is level. To do this simply use a 12mm Spanner to adjust the feet to the appropriate height. See step 9.

Screens

If using screens please remember that screens are to be added at the point the tops are secured to the frame. These cannot be added at a later stage. See step 8.

AURABENCH Assembly Instructions

1. Compile Set 1 (S1) and Set 2 (S2) screws, using parts A, B, C and D. These are required to fit the Bench frame together.
2. Holding both end frames upright, slot the centre crossrails in place to connect the two end frames. Use parts S1 to loosely secure these in place.
WARNING Do not fully tighten screws at this stage.
3. Place the outer crossrails into position using S2 screws. Fully tighten all S1 and S2 screws.
4. Attach the cover plate using parts S1.
5. Insert glide buffers, part E, into the holes in the crossrails.

Continue overleaf

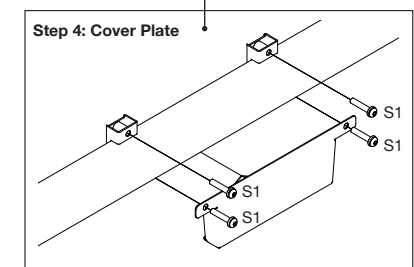
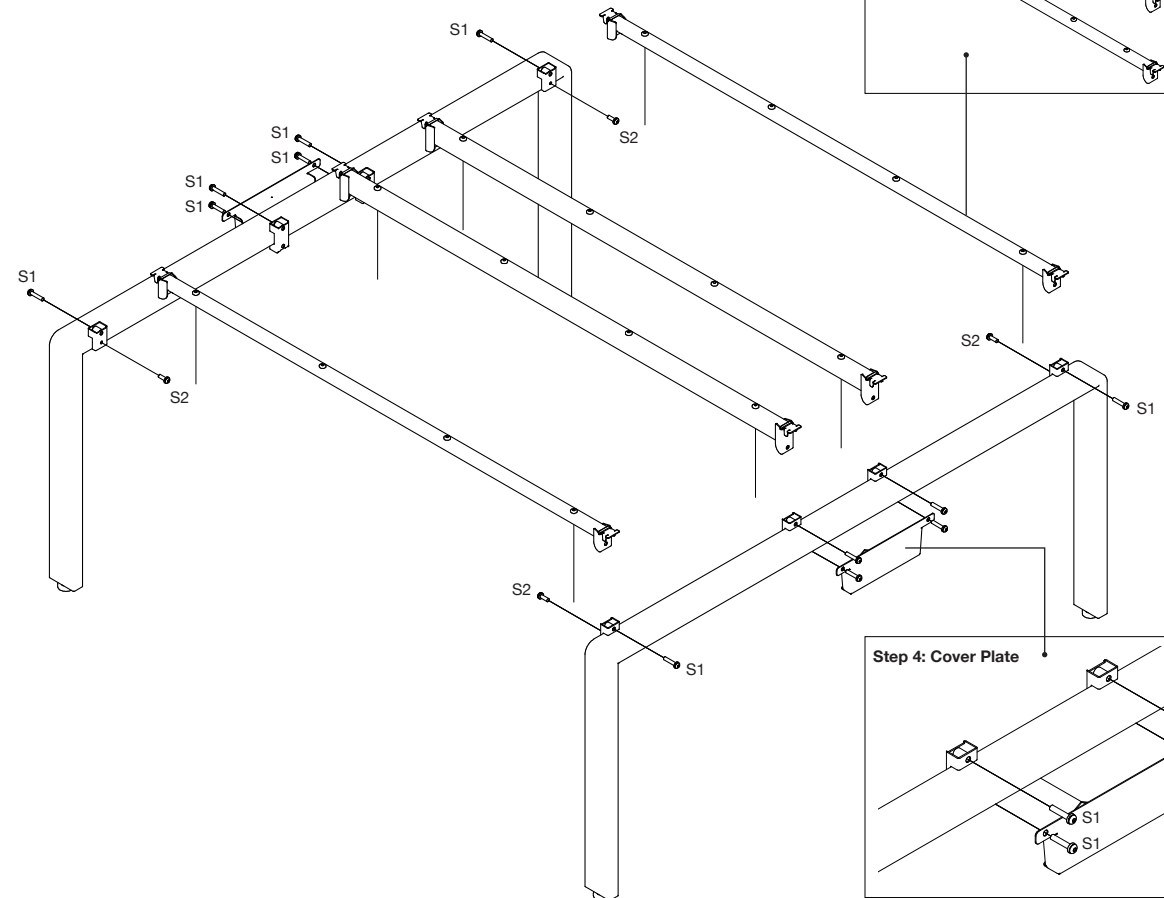
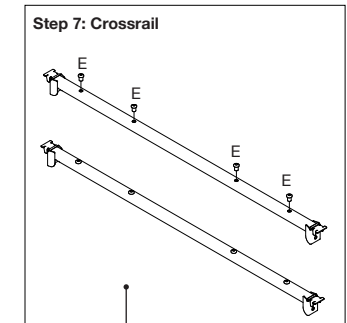
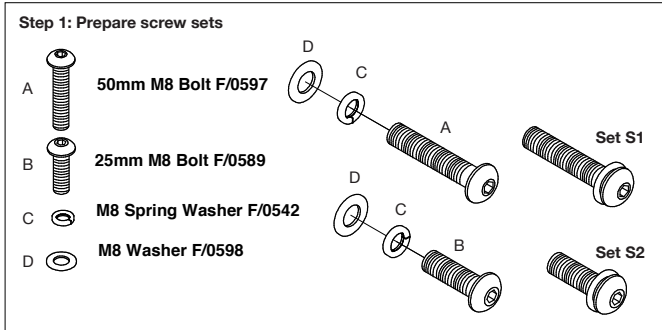

Parts Required

- | | | |
|---|--|--|
| A | | M8 x 50mm Skt Button BZP
Code: F/0597 Quantity = 12 |
| B | | M8 x 25mm Skt Button BZP
Code: F/0589 Quantity = 4 |
| C | | M8 x Contact Spring Washer
Code: F/0542 Quantity = 16 |
| D | | M8 Plain Washer BZP 8mm x 17 x 1.6
Code: F/0598 Quantity = 16 |

- | | | |
|---|--|--|
| E | | Glide / Buffer Drilled 15mm x 18mm
Code: F/0606 Quantity = 16 |
| F | | 5.0 x 70mm Pan Pozi BZP
Code: F/0591 Quantity = 8 |
| G | | 5.0 x 45mm Counter Sunk
Code: F/0587 Quantity = 8 |

Tools needed

- | | |
|--|------------------------------|
| | 12mm Spanner
Quantity = 1 |
|--|------------------------------|

- | | |
|--|-------------------------------|
| | 5mm Allen Key
Quantity = 1 |
|--|-------------------------------|



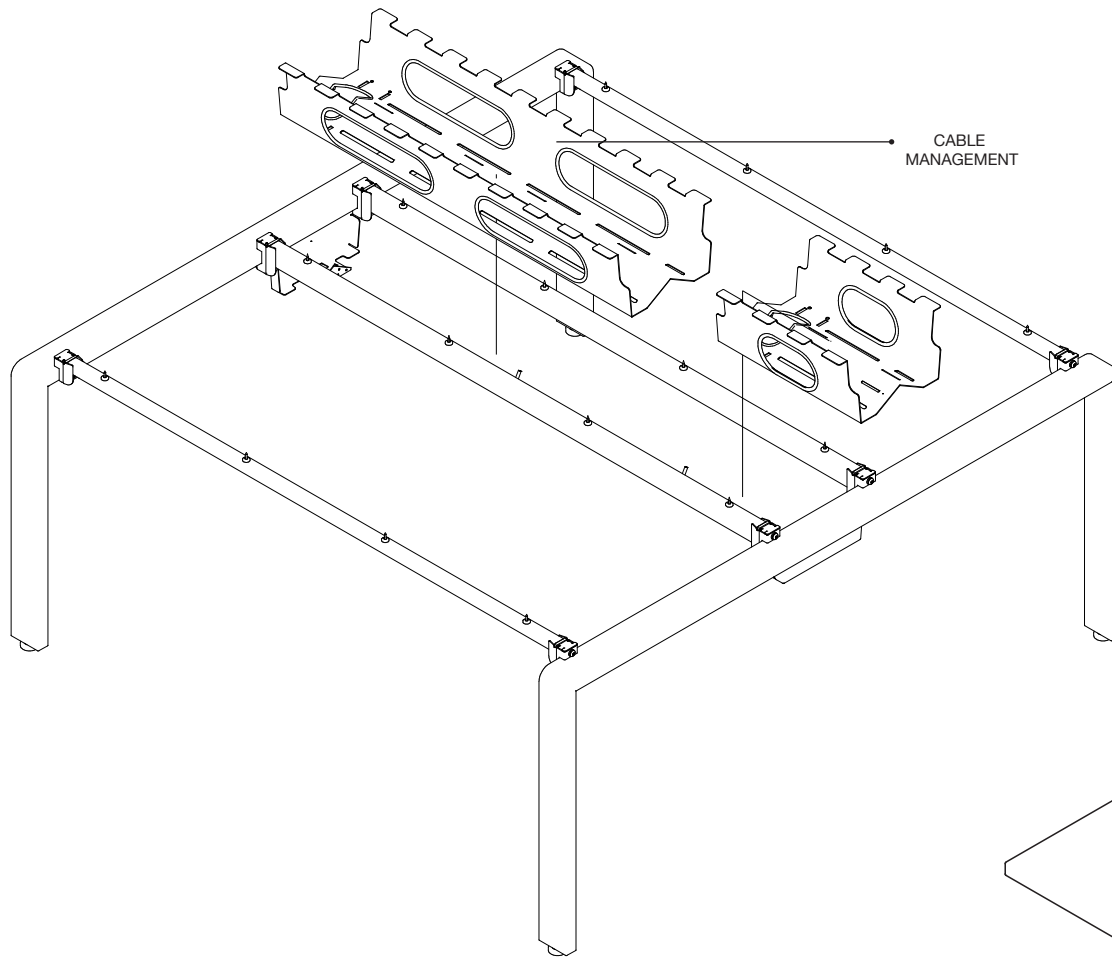

6. Select the various cable management sections and slot onto the centre crossrails, in your desired order.
7. **Optional** If adding a vertical cable tower it is recommended to attach at this stage using instruction leaflet 095.
8. Place one top on to the frame at a time and screw into place using part **F** at the front of the desk and part **G** at the rear of the desk.
9. If adding screens secure only one top and slide the screens into place, then add the second desk top to complete.
10. **WARNING** At this point it is important to adjust the feet to ensure the product is level. To do this simply use a 12mm Spanner to adjust the feet to the appropriate height.
11. The Bench desk is now complete

