

# Atmosphere Gang Socket

## Parts Supplied

### GS2S-BK

<b>Part A</b> A/0853 Gang Socket 2 Switched black Quantity=1	<b>Part B</b> F/0412 5/8" x 6g C/Snk Pozi BZP Quantity=2	<b>Part C</b> A/0691 1" x 1" Double Sided Sqr Pad Quantity=4
--	---	---

### SMC3M-BK

<b>Part D</b> A/0858 Starter Mains Cable Quantity=1	<b>Part E</b> F/0496 Cable Clamp Black Quantity=2	<b>Part F</b> F/0468 M4 x 23mm Handle Screw Quantity=2	<b>Part G</b> F/0559 M4 Flat washer zinc plated Quantity=2	<b>Part H</b> F/0560 M4 Nut zinc plated Quantity=2
---	--	--	---	--

### Cable Tidy 25

<b>Part I</b> Cut down Cable- Trunking Quantity=1
--

Fig.1

Guide to cable configuratoion

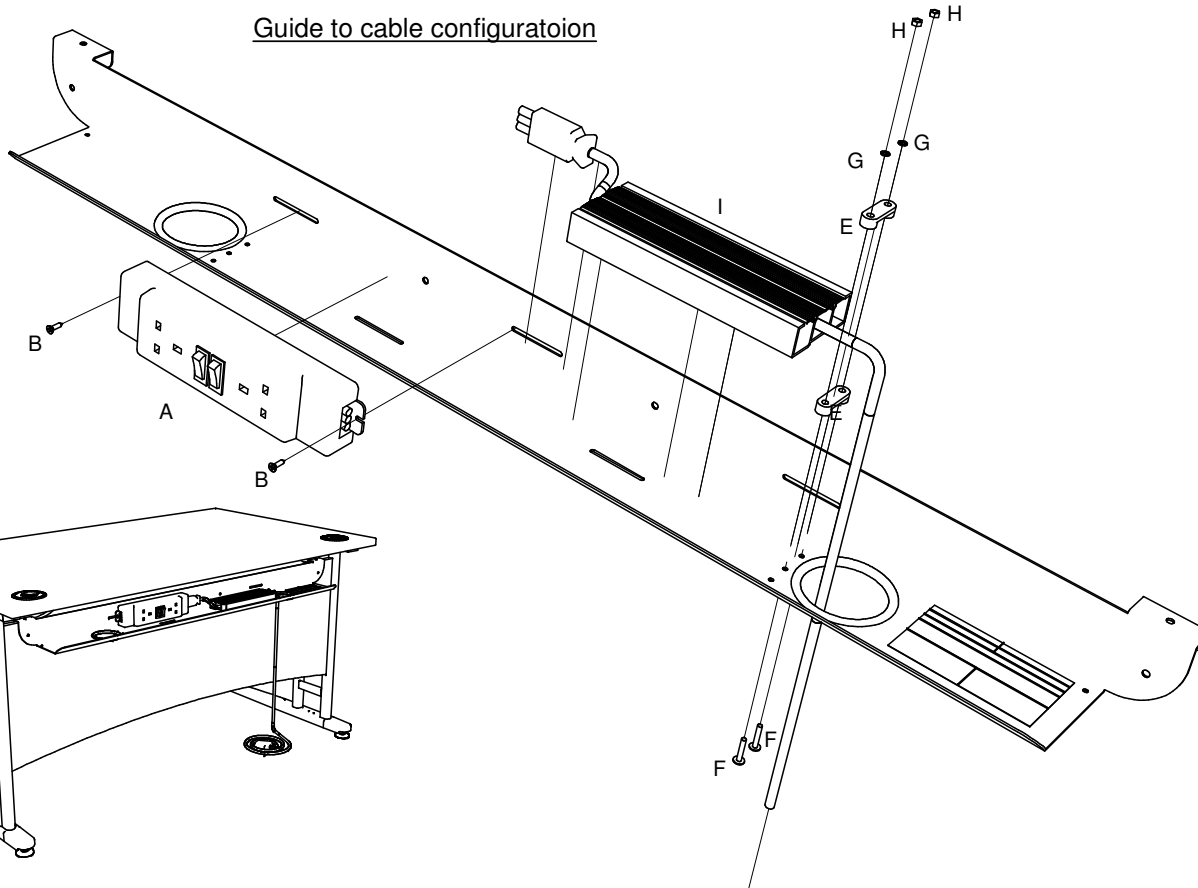
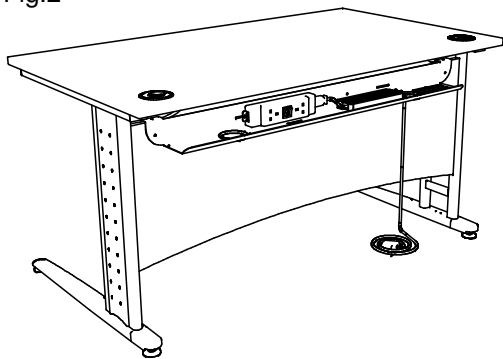

Fig.2



NOTE : The cable tray range can be configured for left or right hand positioning of the power module.  
Do not situate the power module under the cable ports, where split liquid could enter. (Left hand position illustrated Fig.2)

**THIS GANG SOCKET PACK MUST BE USED FOR OFFICE EQUIPMENT ONLY!**

## Guidelines for connecting Gang Socket to Dump Tray.

1) No single item of equipment that has a rated voltage exceeding 250 V or a rated current exceeding 5A is to be connected to this item of furniture.

2) Place the gang socket (part A) with countersunk screws (part B) in position along the wall of the dump tray as shown in fig 1. The sticky pads (part C) are optional instead of screws. For Metal Modesty use bolts provided separately.

**Note: Installer to cut down cable trunking to size. When cutting down cable trunking (part I) to size, be sure to leave at least 100 mm between the power module (part A) and cable trunking (part I), so the power cable connector (in part D) fits. Also leave 20mm between cable trunking and clamp (part E).**

3) Mount the cable trunking (part I) on to the dump tray via adhesive strips between gang socket (part A) and the two clamps (parts E).

4) With starter mains cable attached secure cable clamps (parts E).

**Note: A) It is essential that the electrical system be connected to an electrical supply that has a protective (earth) conductor.**

**B) The advice of a person competent in electrical installation matters shall be sought to ensure that this installation is safe.**

Lee & Plumpton/ Attleborough (01953) 453830  
Designed to comply with BS 6396:2002/ 240V/ 50Hz/  
13A max.

## Instructions for the testing of this equipment. As required to conform to BS 6396: 2002.

### 1. CONTINUITY AND POLARITY

A test of all conductors, including the protective earth conductor, shall be made to verify their continuity and correct polarity. This test shall include the supply cord and plug. The electrical system shall be inspected to ensure that any fuses and any single pole switches fitted are connected only in the live conductor.

The values for resistance of earthing conductors shall not exceed 0.1 Ohm.

### 2. INSULATION RESISTANCE

The insulation resistance of completed electrical installations shall be tested using a 500 V D.C. test supply. The measured resistance shall be not less than 1 M ohm. Tests shall be made between conductors and also to earth of the supply cable.

The duration of each test shall be not less than 5 seconds.

NOTE. Neon indicators shall be removed from the circuit before carrying out this test between conductors by switching off the socket outlet. Where luminaries contain sensitive electronic components, these shall be disconnected prior to the test ( see 713-04-04 of BS 7671).

### 3. EARTH CONTINUITY

Earth connections of the installed socket outlets and the accessible metal parts of earthed office furniture shall be tested by passing a current of not less than 1.5 times the rating of the supply plug fuse and no greater than 25 A, derived from an a.c. source with a load voltage not exceeding 12 V. The tests shall include the supply cord and shall be carried out between the earth pin of the supply plug, the earth connections of the installed socket outlets and where applicable the accessible metal parts of earthed furniture.

The duration of the tests shall be for a period of between 5 s and 20 s. The resistance shall not exceed 0.1 Ohm.