

# Atmosphere Meeting Point -Trumpet Base Assembly

## Tools required



Pozi head screw driver



Allen key (4mm)

## Parts Supplied Specific to 1000MP

Part K  
M/0654-S  
Quantity = 1

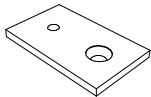

Part L  
F/0414  
Quantity = 2

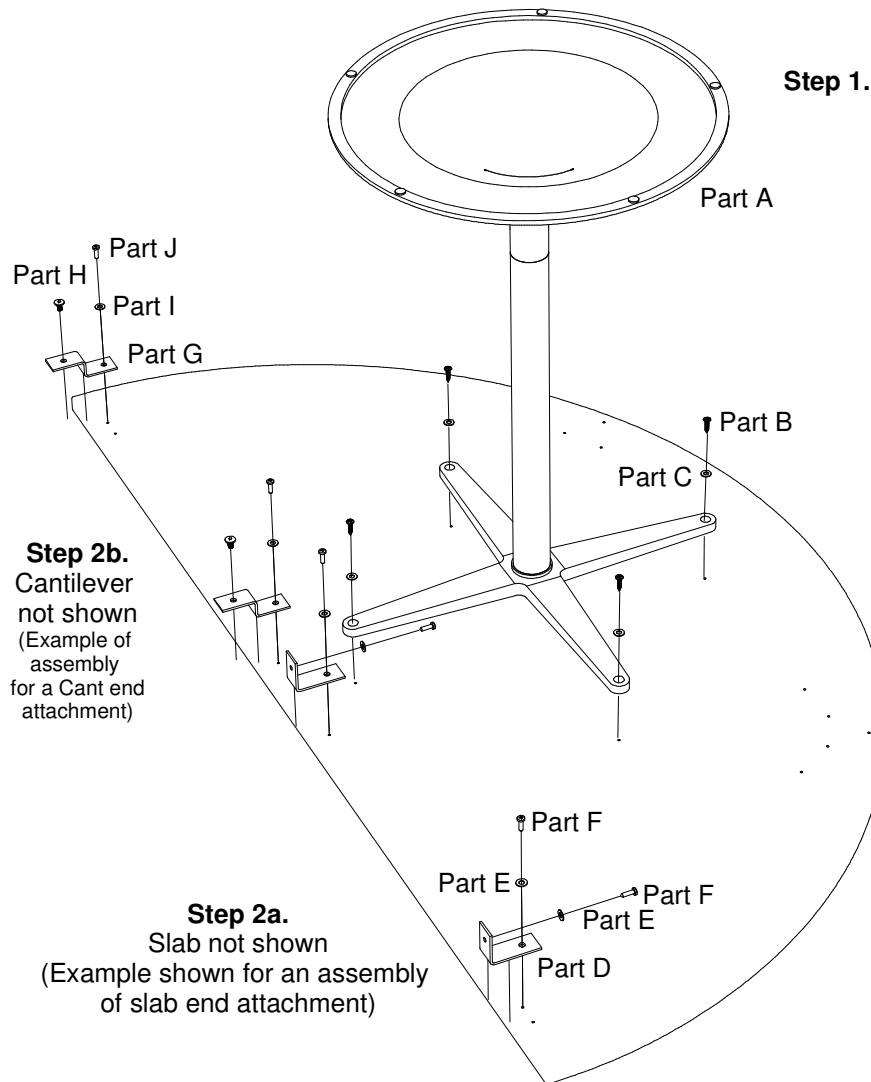

## Assembly steps

### Step 1. Fixing the trumpet base

1. Assemble the trumpet base using the instructions provided.
2. Place top upside down on a soft clean surface.
3. Align the trumpet base (part A) to the holes on the underside of the top.
4. Fix the trumpet base to the top using the four washers (parts C) and screws (parts B).
5. Stand the product on the base and level the accompanying desks to the height of the Meeting Point.

### Step 2. Adding the brackets

#### 2a. Follow if fixing to slab ends

1. Position the brackets (parts D) so they are aligned with the correct holes on the top as shown.
2. Ensuring the brackets are pushed firmly against the slabs, fix the brackets to top using the washers (parts E) and screws (parts F).
3. Fix the brackets to the slabs using the washers (parts E) and screws (parts F). It may be necessary to create pilot holes before adding the screws.

Note: Part K is used on 1000mm only, Secure to pilot hole in meeting point located at the front end of the desk using part L. Pilot drill hole to desk top and secure wing with part L.

#### 2b. Follow if fixing to cantilever ends

1. Position the brackets (parts G) so they are aligned with the correct holes on the top and cantilever as shown.
2. Fix the brackets to the cantilever frame using the bolts provided (parts H).
3. Fix the brackets to the top using the washers (parts I) and screws (parts J).

Note: Part K is used on 1000mm only, Secure to pilot hole in meeting point located at the front end of the desk using part L. Pilot drill hole to desk top and secure wing with part L.

# Atmosphere Meeting Point -Round Leg Assembly

## Tools required

Pozi head screw driver



Allen key (4mm)



## Parts Supplied Specific to 1000MP

Part K  
M/0654-S

Quantity = 1

Part L  
F/0414

Quantity = 2

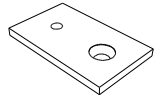

## Step .1



Part D

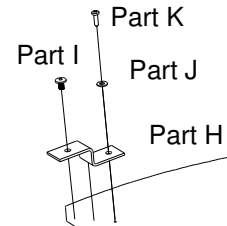

**Step 2b.**  
Cantilever not shown  
(Assembly shown for Cant end attachment)

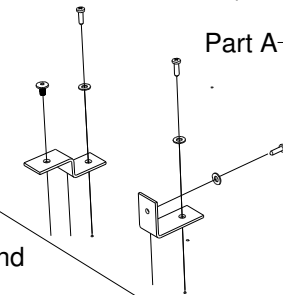

**Step 2a.**  
Slab not shown  
(Assembly shown for slab end attachment)

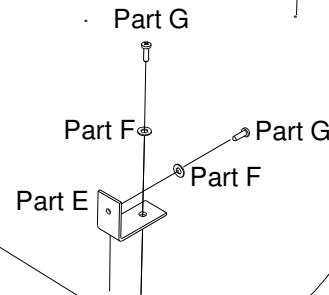

## Assembly steps

### Step 1. Fixing the round legs

1. Place top upside down on a soft clean surface.
2. Position bolts (parts A) in the underside of leg plates (parts B) as shown
3. Align the leg plates (parts B) to the holes on the underside of the top.
4. Fix the leg plates to the top using the screws (parts C) as shown.
5. Screw the legs (parts D) on to the leg plates.
6. Stand the product onto the legs. With two people holding the unsupported edge of the product, level to the height of the desks.

### Step 2. Adding the brackets

2a. Follow if fixing to slab ends. (Two people should hold the unsupported edge at each side of the panel until fixed).

1. Position brackets (parts E) aligning them with correct holes on the top as shown.
2. Ensuring brackets are pushed firmly against slabs, fix the brackets to top using the washers (parts F) and screws (parts G).
3. Fix the brackets to the slabs using the washers (parts F) and screws (parts G). It may be necessary to create pilot holes before adding the screws.

2b. Follow if fixing to cantilever ends. (Two people should hold the unsupported edge at each side of the panel until fixed).

Note: Part K is used on 1000mm only, Secure to pilot hole in meeting point located at the front end of the desk using part L. Pilot drill hole to desk top and secure wing with part L.

1. Position the brackets (parts H) so they are aligned with the correct holes on the top and cantilever as shown.
2. Fix the brackets to the cantilever frame using the bolts provided (parts I).
3. Fix the brackets to the top using the washers (parts J) and screws (parts K).

Note: Part K is used on 1000mm only, Secure to pilot hole in meeting point located at the front end of the desk using part L. Pilot drill hole to desk top and secure wing with part L.