



LEE & PLUMPTON

Inspiration At Work

TABLES



FILT-TOP



Fire action
If you discover a fire
1. Raise the alarm
2. Evacuate the building
3. Report to person in charge of emergency
4. Do not stop to collect your personal belongings

EXIT

NOTICE



Features & Details

- Robust, durable mechanism.
- Sturdy design for stability.
- Quality, locking castors for easy manoeuvring.
- 25mm table tops.

TABLE SHAPES

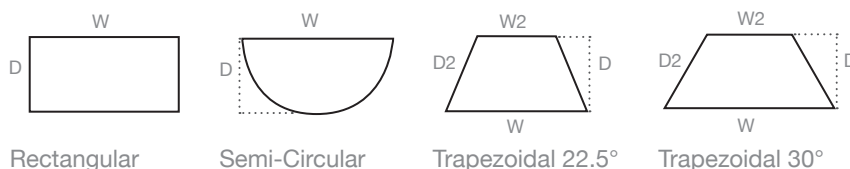

SPECIFICATION

- 25mm/18mm top made from grade E1 melamine faced high density particle board.

FRAME

- Durable release and flip mechanism for ease of storage when not in use.
- All castors are lockable.
- A linking mechanism is available.

LINKING MECHANISM



Linking mechanism open



Linking mechanism closed



QUICK SHIP

Wood Finishes



BI Birch MA Maple WA Walnut

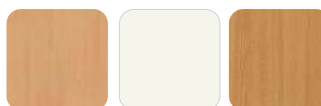

BE Beech WH White LO Light Oak

Metal Finishes



S Silver C Chrome Paint

GROUP A

Wood Finishes



NN Natural Nebraska Oak NN Grey Nebraska Oak

Metal Finishes



S Silver C Chrome Paint

Please add the metal and wood suffix to your code when ordering eg: TTRE16SBI

Wood finishes are heat, stain and scratch resistant when used for their intended purposes.

QS: Quick Ship | **GROUP A:** Subject to a longer lead time.

● Available
○ Not Available



RECTANGULAR



W x D x H (mm)	Code	QS	Grp A
1200 x 800 x 720	TTRE12	●	●
1400 x 800 x 720	TTRE14	●	●
1600 x 800 x 720	TTRE16	●	●
1800 x 800 x 720	TTRE18	●	●

SEMI CIRCULAR



W x D x H (mm)	Code	QS	Grp A
1600 x 800 x 720	TTSC16	●	●

TRAPEZOIDAL



W x W2 x D x D2 x H (mm)	Code	QS	Grp A
Trapezoidal 22.5°			
1412 x 800 x 740 x 800 x 720 *	TTTP14Z2	●	●
Trapezoidal 30°			
1600 x 800 x 693 x 800 x 720 *	TTTP16Z3	●	●

* Both the 22.5° and the 30° Trapezoidal fit to the 800mm table end.

LINKING MECHANISM



Description	Code	QS	Grp A
Links 2 Tilt Top tables (2 per pack)	TTFTLMECH	●	●



FOLDING TABLES





Features & Details

- Stackable for efficient storage.
- Robust, durable mechanism.
- Steel frame for added stability.
- 25mm table tops.

TABLE SHAPES

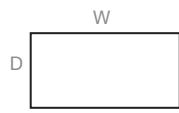

Rectangular

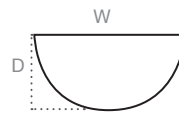

Semi-Circular

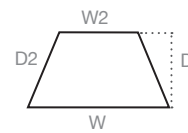

Trapezoidal 22.5°

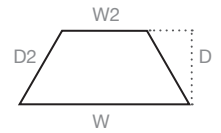

Trapezoidal 30°

SPECIFICATION

- 25mm top made from grade E1 melamine faced high density particle board.

FRAME

- Legs neatly fold under the table to enable easy storage.
- Tables are stackable.
- Tubular steel frame with strong metal supports and curved base.
- Height adjustable feet to reach 725mm.
- Legs supplied with angled anti-slip feet.
- A linking mechanism is available.

LINKING MECHANISM



Linking mechanism open



Linking mechanism closed

QUICK SHIP

Wood Finishes



BI Birch MA Maple WA Walnut

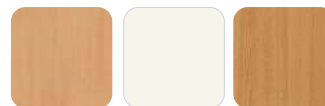

BE Beech WH White LO Light Oak

Metal Finishes



C Chrome Paint

Wood finishes are heat, stain and scratch resistant when used for their intended purposes.

GROUP A

Wood Finishes



NN Natural Nebraska Oak NN Grey Nebraska Oak

Metal Finishes



C Chrome Paint

Please add the metal and wood suffix to your code when ordering eg: FTRE16CBI



QS: Quick Ship | GROUP A: Subject to a longer lead time.

- Available
- Not Available



RECTANGULAR



W x D x H (mm)	Code	QS	Grp A
1200 x 800 x 715	FTRE12C	●	●
1400 x 800 x 715	FTRE14C	●	●
1600 x 800 x 715	FTRE16C	●	●
1800 x 800 x 715	FTRE18C	●	●

SEMI CIRCULAR



W x D x H (mm)	Code	QS	Grp A
1600 x 800 x 715	FTSC16	●	●

TRAPEZOIDAL



W x W2 x D x D2 x H (mm)	Code	QS	Grp A
Trapezoidal 22.5°			
1412 x 800 x 740 x 800 x 715*	FTTP14Z2C	●	●
Trapezoidal 30°			
1600 x 800 x 693 x 800 x 715*	FTTP16Z3C	●	●

* Both the 22.5° and the 30° Trapezoidal fit to the 800mm table end.

LINKING MECHANISM



Description	Code	QS	Grp A
Links 2 Folding Tables (2 per pack)	TTFTLMECH	●	●



DURABLE TABLES

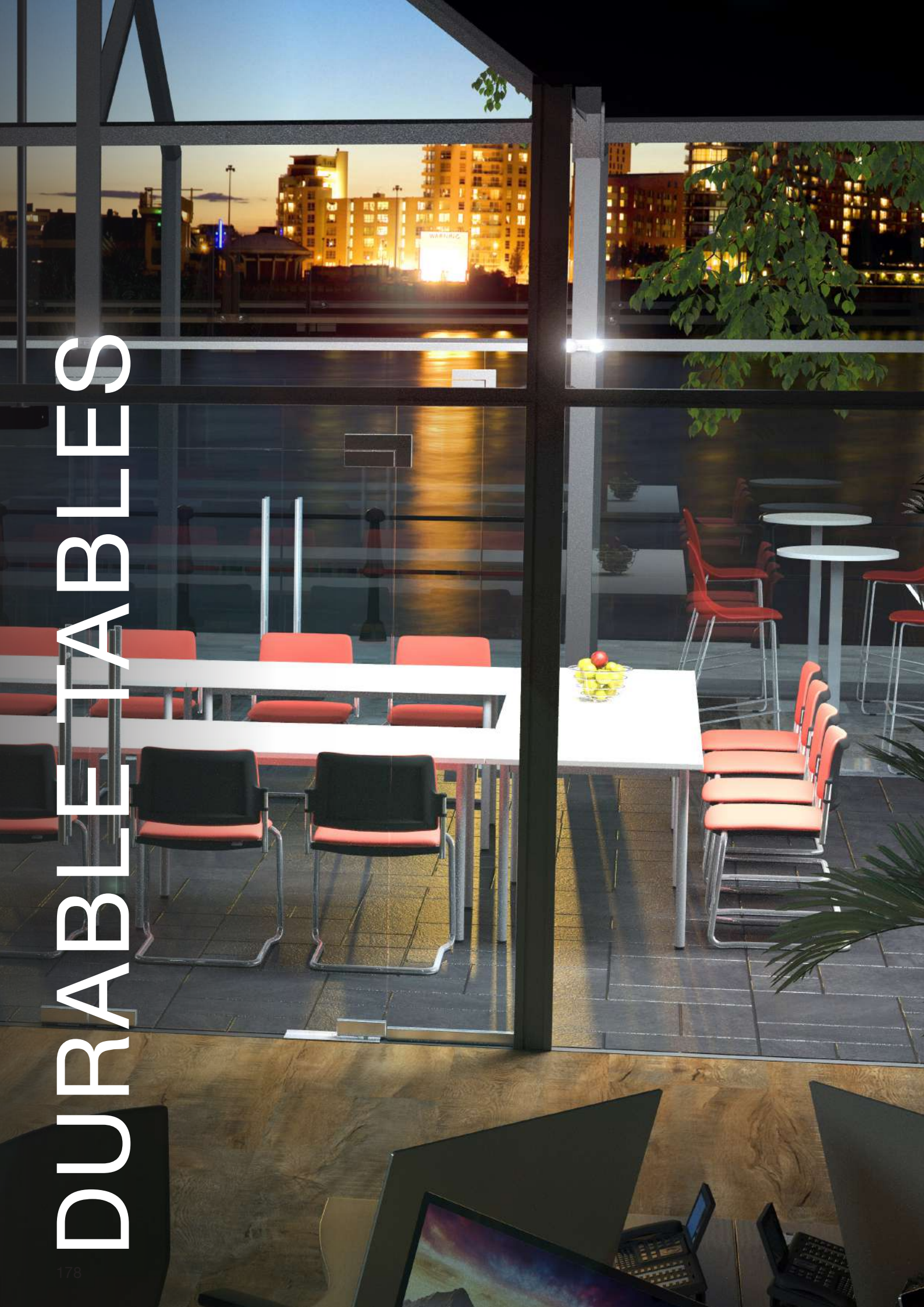



Features & Details

- Welded steel underframe for strength.
- 38mm round legs for maximum stability.
- Choice of sizes and shapes for versatile configurations.
- 25mm table tops.

TABLE SHAPES

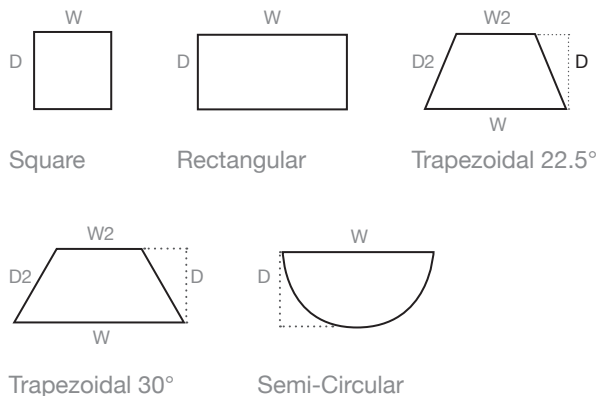

SPECIFICATION

- 25mm top made from grade E1 melamine faced high density particle board.
- Cable management and power modules available. See pages 128 and 130-131.

FRAME

- 38mm round legs using 2mm welded steel for strength and stability.
- Height adjustable feet.



QUICK SHIP

Not Available

Wood finishes are heat, stain and scratch resistant when used for their intended purposes.

Please add the metal and wood suffix to your code when ordering eg: DTSQ66**SBE**

GROUP A

Metal Finishes



S Silver

G Grey

Wood Finishes

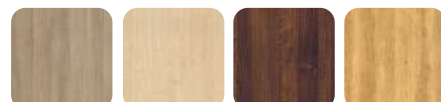

BI Birch

MA Maple

WA Walnut

NN Natural Nebraska Oak



BE Beech

WH White

LO Light Oak

GN Grey Nebraska Oak

QS: Quick Ship | **GROUP A:** Subject to a longer lead time.

● Available
○ Not Available

SQUARE



W x D x H (mm)	Code	QS	Grp A
660 x 660 x 725	DTSQ66	○	●

RECTANGULAR



W x D x H (mm)	Code	QS	Grp A
1200 x 800 x 725	DTRE12	○	●
1400 x 800 x 725	DTRE14	○	●
1600 x 800 x 725	DTRE16	○	●

SEMI CIRCULAR



W x D x H (mm)	Code	QS	Grp A
1600 x 800 x 725	DTSC16	○	●

TRAPEZOIDAL



W x W2 x D x D2 x H (mm)	Code	QS	Grp A
Trapezoidal 22.5°			
1412 x 800 x 740 x 800 x 725	DTTP14Z2	○	●
Trapezoidal 30°			
1600 x 800 x 693 x 800 x 725	DTTP16Z3	○	●

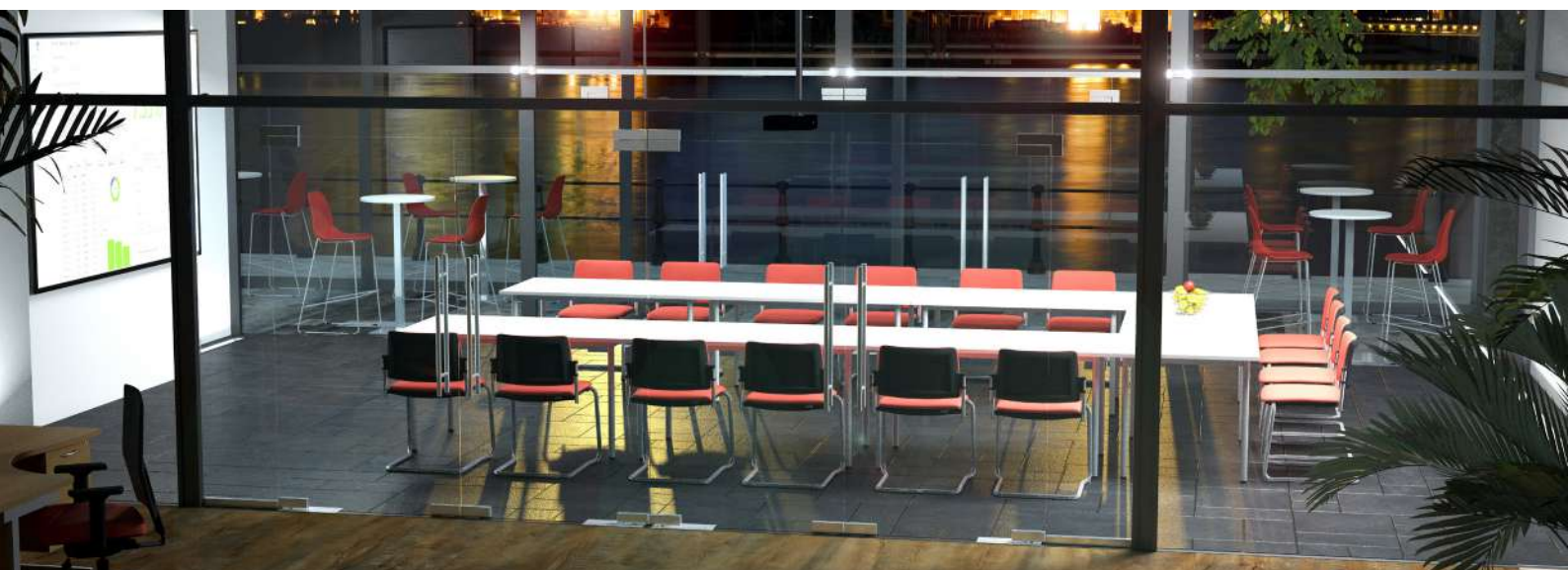

EVERYDAY TABLES



QS: Quick Ship | **GROUP A:** Subject to a longer lead time.

● Available
○ Not Available



ROUND TABLES

Features & Details

SPECIFICATION

- 25mm top made from grade E1 melamine faced high density particle board.
- Cable management and power modules available. See pages 128, and 130-131.

FRAME OPTIONS

- A variety of steel frame options are available including column base, round legs or square legs.



Column Base



Round Legs



Square Legs

W x H (mm)	Code	QS	Grp A
Column Base			
1000 x 725, Base Diameter 600mm, 25mm Top	TBRN10CB	●	●
1200 x 725, Base Diameter 600mm, 25mm Top	TBRN12CB	●	●
Round Legs			
1000 x 725, 25mm Top	TBRN10RL	●	○
1200 x 725, 25mm Top	TBRN12RL	●	○
Square Legs*			
1200 x 720, 18mm Top	TBMT12SQ	●	○

CHAIRS & STOOLS

Browse our range of contemporary chairs and stools from pages 199-205.



Lingwood
Chairs



Ashby
Chairs



Wroxham
Armchairs

QUICK SHIP

Metal Finishes

Round Legs



S Silver G Grey I Iron Grey

Column Base



S Silver

Square Legs



G Grey B Brown

Wood Finishes



BI Birch MA Maple WA Walnut



WH White LO Light Oak BE Beech

GROUP A

Metal Finishes

Column Base

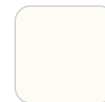

W White

Wood Finishes



NN Natural
Nebraska Oak GN Grey
Nebraska Oak

* BI, WA and WH tops for square legged tables are only available on a standard lead time. Quick Ship is unavailable.

See Wood Finishes left. The finishes listed left are also available on a longer lead time if required.

Wood finishes are heat, stain and scratch resistant when used for their intended purposes.

Please add the metal and wood suffix to your code when ordering eg: TBRN10CBSBI

QS: Quick Ship | **GROUP A:** Subject to a longer lead time.

- Available
- Not Available



UNIVERSAL TABLES

Features & Details

SPECIFICATION

- 25mm or 18mm top made from grade E1 melamine faced high density particle board.
- Cable management and power modules available. See pages 128, and 130-131.

FRAME OPTIONS

- A variety of frame options are available including round legs, square legs and cantilever I frame.

TABLE SHAPES

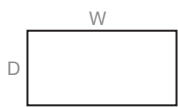

Rectangular

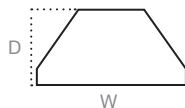

D End



QUICK SHIP

Square Legs



G Grey / BE Beech **G Grey / MA Maple** **G Grey / LO Light Oak** **B Brown / LO Light Oak**

Round Legs



S Silver / BE Beech **S Silver / MA Maple** **S Silver / LO Light Oak** **G Grey / BE Beech** **G Grey / MA Maple** **G Grey / LO Light Oak** **I Iron Grey / BE Beech** **I Iron Grey / MA Maple** **I Iron Grey / LO Light Oak**

Please Note:

Maple is not available for D-End.

GROUP A

The finishes listed above are also available on a longer lead time if required.

Wood finishes are heat, stain and scratch resistant when used for their intended purposes.

Please add the metal and wood suffix to your code when ordering eg: TBOT12SQGBE

QS: Quick Ship | **GROUP A:** Subject to a longer lead time.

- Available
- Not Available



RECTANGULAR TABLE



Square Legs



Round Legs

W x D x H (mm)	Code	QS	Grp A
Square Legs			
1200 x 615 x 720, 18mm Top	TBOT12SQ	●	●
1500 x 745 x 720, 18mm Top	TBOT15SQ	●	●
1800 x 745 x 720, 18mm Top	TBOT18SQ	●	●
Round Legs			
1200 x 800 x 725, 25mm Top	TBCT12RL	●	●
1600 x 800 x 725, 25mm Top	TBCT16RL	●	●
1800 x 800 x 725, 25mm Top	TBCT18RL	●	●

D-END TABLE



Round Legs

W x D x H (mm)	Code	QS	Grp A
Round Legs			
1200 x 600 x 725, 25mm Top	TBDE12RL	●	●
1600 x 800 x 725, 25mm Top	TBDE16RL	●	●

Maple is not available for D End.

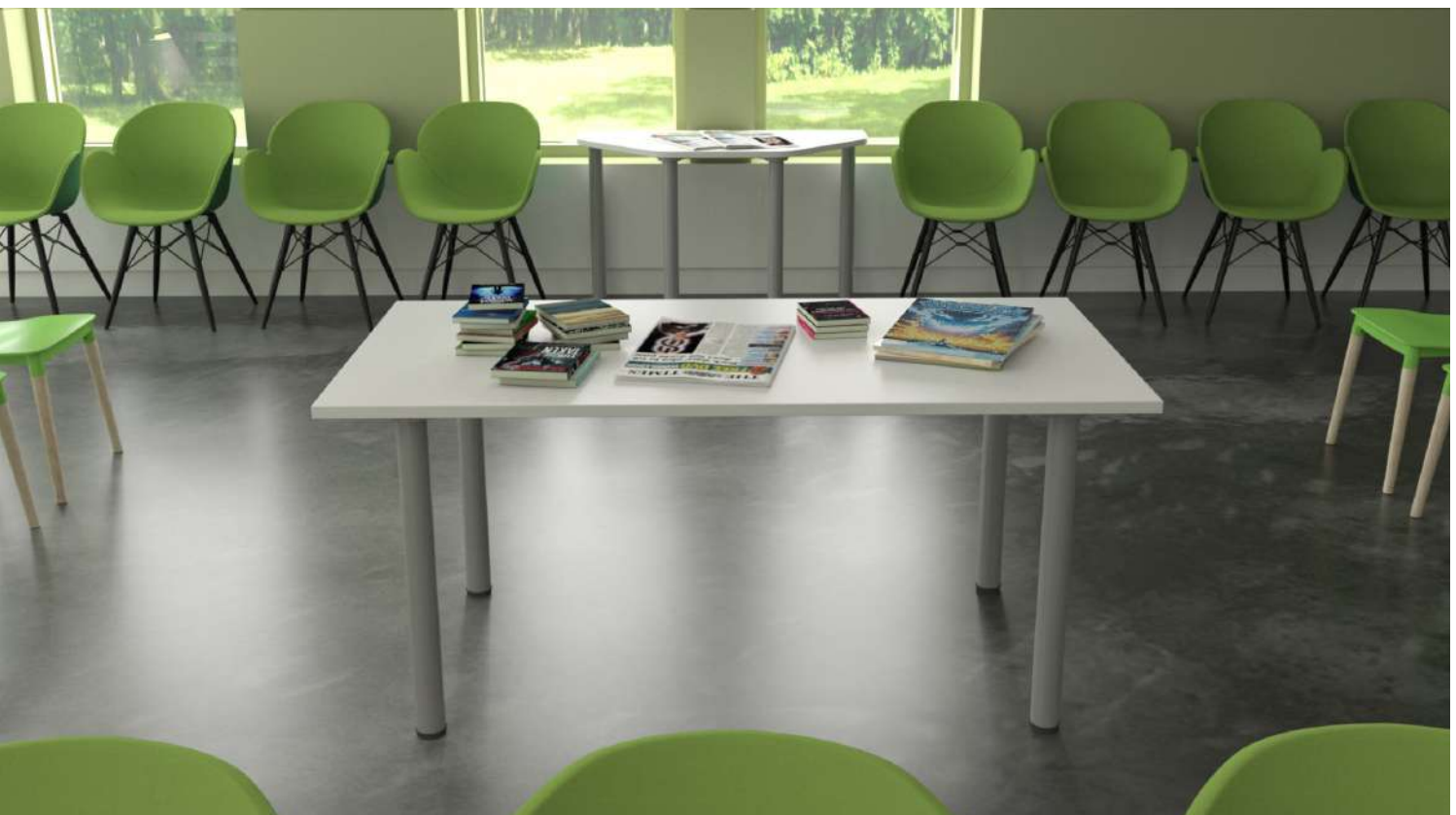



PLANNAR

Features & Details

- Ideal for collaborative spaces and training environments.
- Optional cable management and power modules.
- Poseur and desk height options with coordinating bench seating.
- 25mm table tops and side panels.

SPECIFICATION

- 25mm deep top and panel sides.
- Adjustable feet on tables.
- 18mm twin modesty panels for additional strength.
- Integrated power modules are available.
- An optional seat cushion is available for coordinating benches.



Optional integrated power modules available.



QUICK SHIP

Not Available

Wood finishes are heat, stain and scratch resistant when used for their intended purposes.

Please add the metal and wood suffix to your code when ordering eg: **PLHT18BE**

GROUP A

Wood Finishes

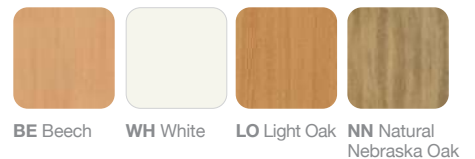
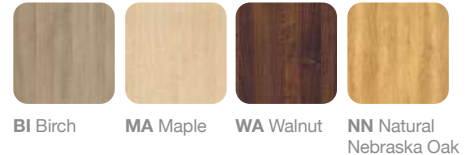

QS: Quick Ship | **GROUP A:** Subject to a longer lead time.

● Available
○ Not Available

PLANAR TALL TABLE



W x D x H (mm)	Code	QS	Grp A
1800 x 900 x 1050	PLHT18	○	●
2000 x 900 x 1050	PLHT20	○	●

PLANAR TABLE



W x D x H (mm)	Code	QS	Grp A
1800 x 900 x 740	PLTB18	○	●
2000 x 900 x 740	PLTB20	○	●

PLANAR BENCH SEAT



W x D x H (mm)	Code	QS	Grp A
1600 x 350 x 460	PLBE16	○	●
1800 x 350 x 460	PLBE18	○	●

Bench seat is set 200mm narrower than the table.

BENCH SEAT CUSHION



W x D (mm)	Code	Group 1	Group 2	Group 3	Group 4	Group 5	Group 6
1600 x 350	PLCU16						
1800 x 350	PLCU18						

(Prices for cushion only, for bench seat see table above).

Simply add the fabric group suffix to your code when ordering. **1, 2, 3, 4, 5, 6** and state the colour fabric you would like.

For colour fabric groups and options please refer to pages 254-259.

FEED YOUR
DREAMS



SLED
SEATS

Features & Details

- Modern, contemporary design.
- A choice of options for meeting and breakout spaces.
- Robust build quality for strength and stability.
- 43mm table tops.

SPECIFICATION

- 43mm deep top.
- Self levelling feet on tables.
- Cable management and power modules available. See pages 128, and 130-131.
- An optional seat cushion is available for coordinating benches.

FRAME

- 50mm steel tube frame.



QUICK SHIP

Not Available

Please add the metal and wood suffix to your code when ordering eg: AUSW14RSBI

Wood finishes are heat, stain and scratch resistant when used for their intended purposes.

GROUP A

Metal Finishes

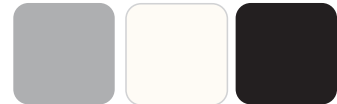

S Silver W White B Matt Black

Wood Finishes



BI Birch MA Maple WA Walnut NN Natural Nebraska Oak

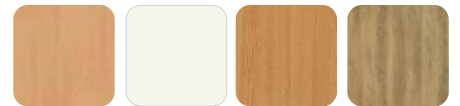

BE Beech WH White LO Light Oak GN Grey Nebraska Oak



QS: Quick Ship | **GROUP A:** Subject to a longer lead time.

● Available
○ Not Available

SLED TALL TABLE



W x D x H (mm)	Code	QS	Grp A
1800 x 800 x 1050	SLHT18	○	●

SLED TABLE



W x D x H (mm)	Code	QS	Grp A
1800 x 800 x 740	SLTB17	○	●

SLED BENCH SEAT



W x D x H (mm)	Code	QS	Grp A
1600 x 350 x 460	SLBE10	○	●

Bench seat is set 200mm narrower than the table.

SLED BENCH SEAT CUSHION



W x D (mm)	Code	Group 1	Group 2	Group 3	Group 4	Group 5	Group 6
1600 x 350	SLCU16						

(Prices for cushion only, for bench seat see table above).

Simply add the fabric group suffix to your code when ordering. **1, 2, 3, 4, 5, 6** and state the colour fabric you would like.

For colour fabric groups and options please refer to pages 254-259.



ELECT

Features & Details

- Sleek styling for a wide variety of interior environments.
- Poseur, desk and coffee table heights for versatility.
- Highly durable brushed steel bases.
- 25mm table tops.

TABLE SHAPES

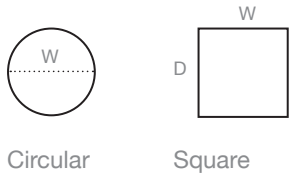

SPECIFICATION

- 25mm top made from grade E1 melamine faced high density particle board.
- Cable management and power modules available. See pages 128, and 130-131.

FRAME

- High quality brushed steel square table base.



QUICK SHIP

Not Available

Wood finishes are heat, stain and scratch resistant when used for their intended purposes.

Please add the metal and wood suffix to your code when ordering eg: **ELCORN80CBBSBI**

GROUP A

Metal Finishes



BS Brushed Steel

Wood Finishes



BI Birch



MA Maple



WA Walnut



NN Natural Nebraska Oak



BE Beech

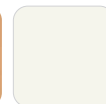

WH White



LO Light Oak



GN Grey Nebraska Oak

QS: Quick Ship | **GROUP A:** Subject to a longer lead time.

● Available
○ Not Available

COFFEE TABLES



Round Table

Square Table

Table	W x H (mm)	Code	QS	Grp A
Round Table	600 x 450	ELCORN60CBB	○	●
Round Table	800 x 450	ELCORN80CBB	○	●
Square Table	600 x 450	ELCOSQ60CBB	○	●
Square Table	800 x 450	ELCOSQ80CBB	○	●

MEETING TABLES



Round Table

Square Table

Table	W x H (mm)	Code	QS	Grp A
Round Table	600 x 720	ELMTRN60CBB	○	●
Round Table	800 x 720	ELMTRN80CBB	○	●
Square Table	600 x 720	ELMTSQ60CBB	○	●
Square Table	800 x 720	ELMTSQ80CBB	○	●

POSEUR TABLES



Round Table

Square Table

Table	W x H (mm)	Code	QS	Grp A
Round Table	600 x 1100	ELPTRN60CBB	○	●
Square Table	600 x 1100	ELPTSQ60CBB	○	●



COORDINATING TABLES



Features & Details

- Coordinating tables from AuraBench, DominoBeam & Ascend ranges.
- Standalone or suite with the office interior.
- Unique design aesthetics.
- 25mm worksurfaces.



QUICK SHIP

Not Available

Please Note:
DominoBeam: Silver or White Metal finish only.

Ascend: White Metal finish only.

Wood finishes are heat, stain and scratch resistant when used for their intended purposes.

Please add the metal and wood suffix to your code when ordering eg: AUSW14RSBI

GROUP A

Metal Finishes

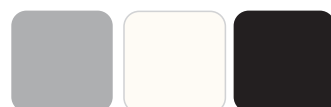

S Silver **W** White **B** Matt Black

Wood Finishes



BI Birch **MA** Maple **WA** Walnut **NN** Natural Nebraska Oak



BE Beech **WH** White **LO** Light Oak **GN** Grey Nebraska Oak

AuraBench Features & Details

- Floating desktop design made from 25mm grade E1 melamine faced high density particle board.
- Height levelling feet.
- Stylish laser cut profile end frame made from a continuous heavy gauge steel tube for extra strength.



TABLES



W x D x H (mm)	Code	QS	Grp A
1200 x 1200 x 740mm	AUBT12BF	○	●
1800 x 1200 x 740mm	AUBT18BF	○	●
2400 x 1200 x 740mm	AUBT24BF	○	●

Our meeting tables have the same stylish floating top and curved frame design as our AuraBench desking range.

QS: Quick Ship | **GROUP A:** Subject to a longer lead time.

● Available
○ Not Available

DominoBeam Features & Details

- Desktop design made from 25mm grade E1 melamine faced high density particle board.
- Integrated cable management.
- Height levelling feet.
- Plus 1 Option to extend the table length.

RECTANGULAR TABLE



W x D x H (mm)	Code	QS	Grp A
1800 x 800 x 725	DMBT18BF	○	●
2400 x 800 x 725	DMBT24BF	○	●

PLUS 1 TABLE



W x D x H (mm)	Code	QS	Grp A
1800 x 800 x 725	DMBT18BFP	○	●
2400 x 800 x 725	DMBT24BFP	○	●

Ascend Features & Details

- Desktop design made from 25mm grade E1 melamine faced high density particle board.
- Metal frame with 1.5mm wall thickness.
- Optional cable management and power modules. See pages 128, and 130-131.



RECTANGULAR TABLE



W x D x H (mm)	Code	QS	Grp A
1200 x 800 x 740	ASAB12AF	○	●
1600 x 800 x 740	ASAB16AF	○	●
1800 x 800 x 740	ASAB18AF	○	●

BARREL TABLE



W x D x D2 x H (mm)	Code	QS	Grp A
2500 x 800 x 1000 x 740	ASAB25AF	○	●

A COMMITMENT TO SERVICE

Dedicated Customer Service

The values of Integrity, Commitment, Development, Accountability and Teamwork underpin the culture and aspirations of the Company. We strive to design and develop an extensive portfolio of quality products which combine aesthetics and practicality to offer Best Value solutions. The ongoing monitoring of every aspect of the business ensures we are able to implement continuous improvements to maintain our determined commitment to customer service.



Inhouse Delivery Fleet

We operate and manage our own delivery fleet and are targeted for accurate, on time order fulfillment. Rapid turnaround is guaranteed by our weekly scheduled deliveries and, on many items, we also offer a 'Quick Ship' service. Standard deliveries are free of charge with next day delivery on stocked items or customer collection (with 24 hours' notice) also available.

- Quick Ship: Products delivered within 5 working days from your order deadline date.
- Group A: Products subject to a longer lead time (typically 3 weeks).



Extensive Stock Holding

Our 200,000 square feet manufacturing base includes an extensive warehousing facility. We hold stock of an estimated 50,000 items including raw materials and finished goods.

This substantial financial investment provides a further demonstration of our determined commitment to the highest levels of customer service.



INHOUSE EXPERTISE

Bespoke Design

Unlike many manufacturers, we are able to develop customised solutions to match each client's precise requirements. With its own production unit and dedicated team, our Bespoke department can design and manufacture products from original 'sketches' or develop existing range items to customised specifications.

Your dedicated account manager, together with a member of the Bespoke team, will work with you to develop a solution to match your requirement and budget.

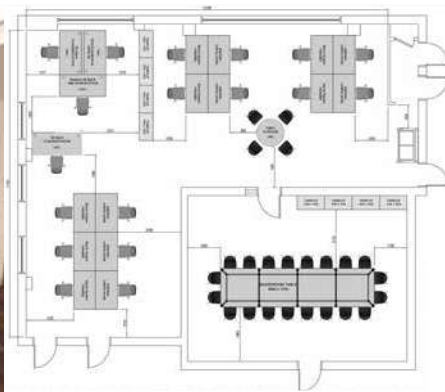

Planning & Design

Our highly experienced designers are available to offer expert space planning and design services. Working from simple sketches or architect plans, we can recommend product choice, configurations and finishes to match desired outcomes and available budget.

We are able to advise regarding effective space utilisation and also work collaboratively to consider lighting, team requirements, storage as well as existing building services and future reconfigurations of any environments.

CGI Expertise

We have an extensive library of product images together with a portfolio of 3D CAD files. Customers can download files from our web site or upon request.

The wide choice of CGI, photo-realistic room scenes can help visualise proposed interiors, colours, and designs.

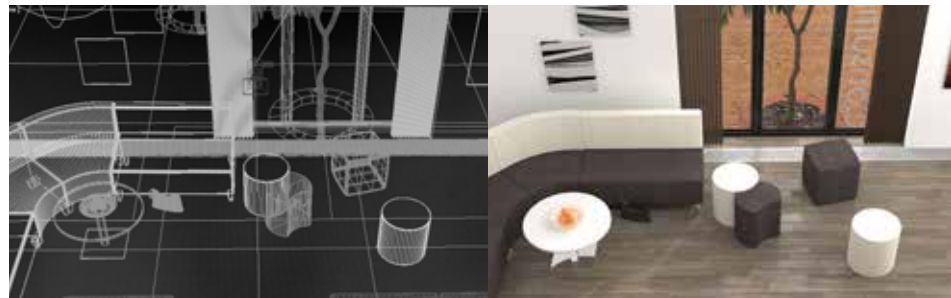

Sales & Customer Support

We know relationships are important. Our nationwide sales team offers 'face to face' meetings to provide expert support, advice and guidance as well as facilitating access to our extensive inhouse services including customised marketing materials, product samples and collaborative events.

Each and every order is carefully monitored and tracked by our customer services team. Fully trained advisors provide a dedicated point of contact to manage queries and requests as well as full after-sales support.

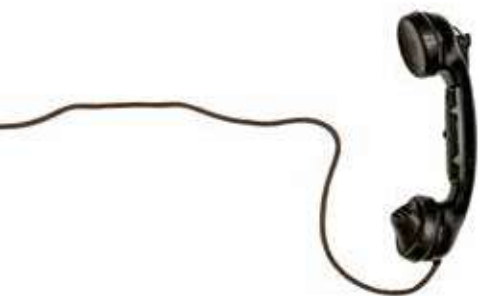

A COMMITMENT TO QUALITY

Continuous investment in facilities and training, coupled with a dedicated workforce and strong supplier relationships, ensures the quality, consistency and reliability our customers expect. The management and measurement of our internal processes and procedures drives our quest for development and improvement and, therefore, ongoing customer satisfaction.

We have an established reputation for the supply of robust, quality products. We design and manufacture to comply with relevant British and international standards – covering dimensions; ergonomics; strength & stability; moving parts; fire regulations; and electrical systems. The inherent strength and durability means that our products will withstand the rigours of daily ‘wear and tear’ thus extending the lifecycle. Our furniture includes a 7-year guarantee (unless specified).

Copies of our credentials and certifications are available at leeandplumpton.co.uk



Quality Management System BS EN ISO 9001



Environmental Management System BS EN ISO 14001



Occupational Health And Safety Management System OHSAS 45001 (OH&S)



Commercial Interiors U.K. (CIUK)



Established 1987

Commercial Furniture Advisory Service (CFAS)



Members Of Furniture Industry Research Association (FIRA)



RESPONSIBLE MANUFACTURING

As a major manufacturer, we recognise our responsibility to consider all areas of our business in terms of environmental impact. From management, administration and product design through to facilities management and logistics together with manufacturing processes and procedures, we strive to introduce positive changes to protect the planet.

Our efforts embrace the full spectrum of business activities including reductions in carbon emissions through to waste prevention, recycling initiatives, transportation, investment in solar power and procurement practices. Sustainability and circularity principles are embedded within our product design and development processes. We are committed to minimising our carbon impact and working towards a greener future.

Environmental Management

We measure and assess our efforts through our integrated Environmental Management System. Registered to ISO 14001: 2015, our system incorporates clear objectives which are monitored and measured through a documented programme with regular reviews for continuous improvement.



Chain of Custody

Our Chain of Custody certification (COC) with the Forest Stewardship Council® (FSC®) represents the unbroken path that certificated products take, from the sustainably managed forests of origin, to the consumer.



The mark of responsible forestry

Sustainability

Created in 2006, the Furniture Industry Sustainability Programme (FISP) has become established as the furniture industry forum on all environmental and sustainability issues. These considerations relate to all aspects of the industry's business, from purchasing and procurement through to end of product life, including social, ethical and employment concerns as well as waste, energy and emissions.

We have achieved full membership of FISP and this enables us to focus on reducing our social and environmental impact. We have been proud members of the Furniture Industry Sustainability Programme (FISP) since 2007. Membership is subject to regular independent re-audits to monitor our continuing commitment.



Energy Management

Our energy management strategy includes a number of practices to minimise usage throughout all areas of the business. In addition, in the last year our solar panels have generated over 160,000 Kwh of electricity. Nearly half of the output is returned to the National Grid – sufficient to power 26 three/quarter bedroom homes for a year.



LEE & PLUMPTON

Bunns Bank | Attleborough Norfolk | NR17 1QD
T: 01953 453830 | E: sales@leeandplumpton.co.uk

leeandplumpton.co.uk



@LEEANDPLUMPTON

October 2022_v1.1

E&OE October 2022

Images featured within this brochure are for illustrative purposes and appearances may vary from those shown. Due to our ongoing initiatives, Lee & Plumpton Ltd. reserve the right to change, modify or delete products at any time without notification.

